



# FEATURES OF THE MMSD RAIN BARREL

One rain barrel and one diverter kit

# WHAT'S INCLUDED?

1. Barrel
2. Lid



## Kit Inside the Rain Barrel:

3. Fill Hose
4. Fill Hose Seal
5. Spigot and Threaded Seal
6. Drain Assembly and Threaded Seal
7. FlexiFit Diverter
8. Winterization Hole Cover
9. 2 Piece Hole Saw Set (1-1/2" and 2-1/8")
10. Plant Top Filter
11. Screws (4)

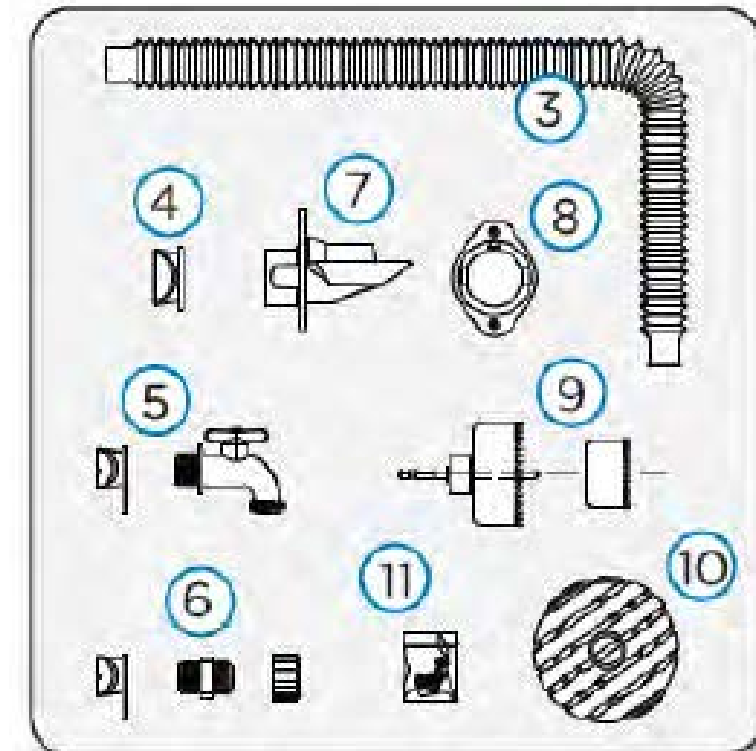

## TOOLS YOU WILL NEED:

- Safety glasses
- Safety gloves
- Phillips screwdriver
- Pencil
- Measuring tape or ruler
- Level
- Drill
- Crushed Gravel (paver base)
- Stand/base, must be sturdy

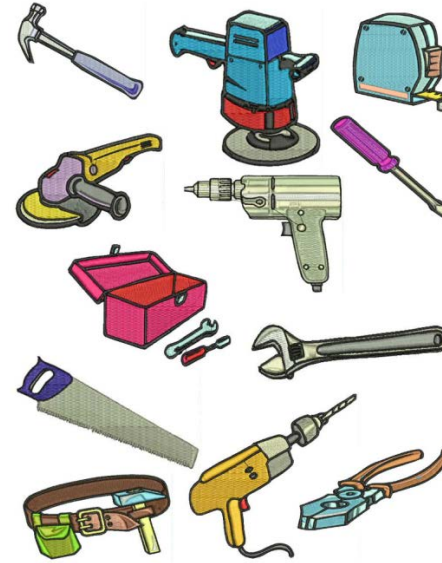



# RAIN BARREL INSTALLATION

Install in less than  
one hour

1. Insert the small threaded seals into the 2 holes in the front of the barrel



2. Twist the drain assembly into the bottom threaded seal, and the spigot into the top threaded seal



# RAIN BARREL INSTALLATION

3. Place barrel on base and determine which side the diverter hose should go
4. Level the ground by loosening the soil, adding crushed gravel, and tamping down the dirt

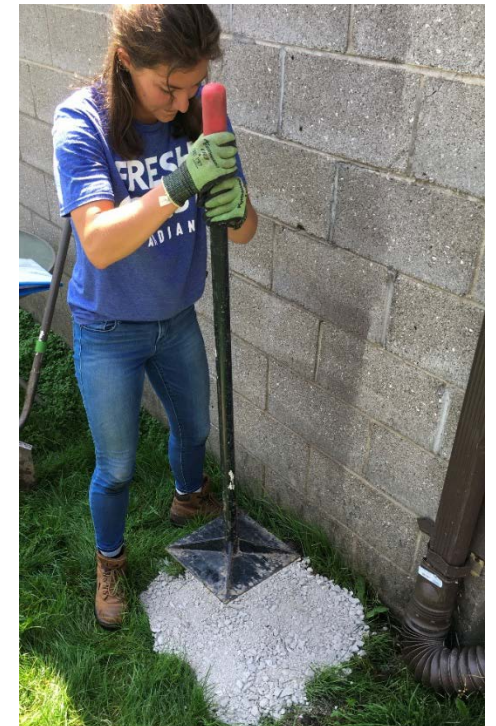



# RAIN BARREL INSTALLATION

**5. Place base on the level ground**



**6. Drill hole on the raised flat surface (that you already selected) using the smaller sized hole saw (1.5" in diameter), then attach rubber seal**



# RAIN BARREL INSTALLATION

7. Determine where to drill into the downspout. 3" down from top of barrel without the lid on (while on the base) Note: For 2x3" downspout drill into the front and for 3x4" downspout drill into the side



8. Drill hole in downspout using the large hole saw (2-1/8"). File down the sharp edges.



# RAIN BARREL INSTALLATION

9. Install diverter piece by squeezing the rubber piece and putting it into the hole you drilled, then use 2 screws to secure in place





# RAIN BARREL INSTALLATION

**10. Attach fill hose into the rubber seal of the barrel and connect the other end of the hose to the diverter in the downspout**

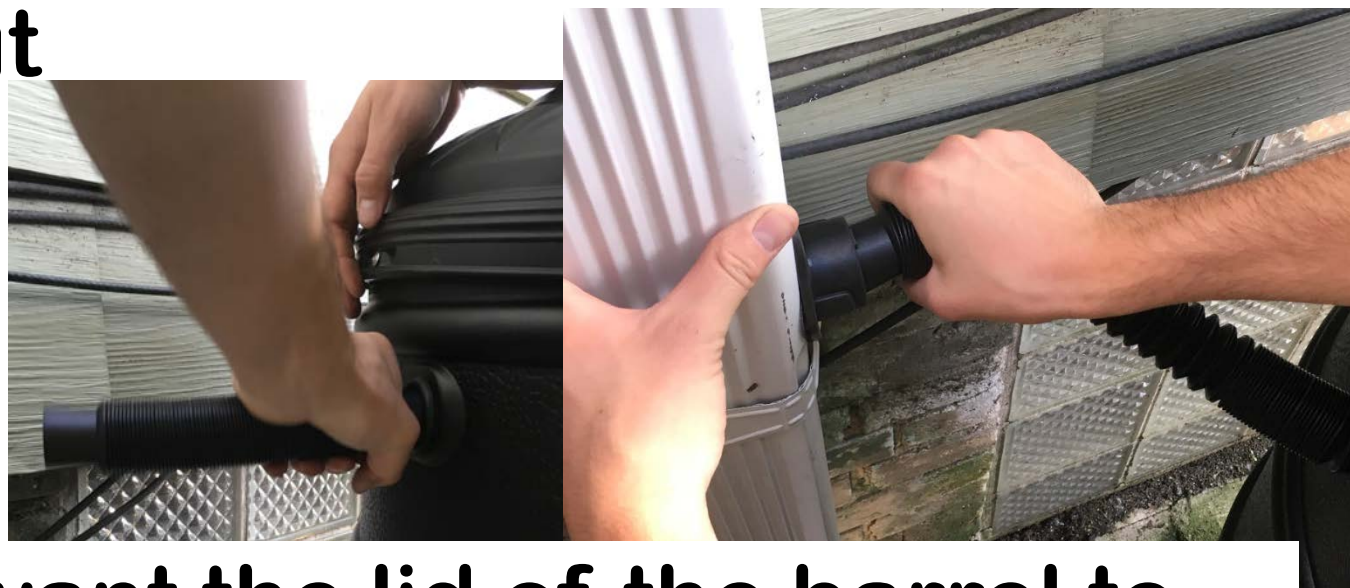

**11. Pick which way you want the lid of the barrel to be on (right-side up to show the sunflower, or upside down to be able to put plants in. Screw the lid onto the barrel if you want it to be sturdier.**

# A FEW HELPFUL HINTS...

What should you use as a stand?

Cinderblocks

Bricks

Wooden stand

Should be able to hold 450lbs!

Use 4x4s for legs of stand, Green Treated or Cedar

Water isn't flowing to the barrel – what's wrong?

Three reasons why water may not flow into the barrel:

1. Barrel is too high, relative to the diverter. The hole on the back of the barrel should be below the diverter hole in the downspout.
2. Downspout/Gutter is clogged
3. Fill hose is clogged

**DO NOT INSTALL IF YOUR ROOF OR GUTTERS NEED MAINTENANCE**





# MAINTENANCE

## Spring:

1. Wash out debris that might have collected over winter out
2. Check spigot and other fasteners for tightness

## Summer:

1. Empty within a few days of raining (this keeps down on smell and algae growth)
2. Check for leaves caught in diverter from time to time

## Fall/Winter:

1. Disconnect the barrel from the downspout and insert winterizing cap
2. Clean and store barrel upside down in your basement or garage

